

PROJECT CATALOGUE

# NORDLIV BYG

2026

## OFFICE RENOVATIONS BUILT ON TRUST, QUALITY AND MANAGEMENT

At Nordliv Byg, we prioritise transparency, quality and strong professional relationships. For corporate real estate stakeholders, choosing the right partner is essential – and that is exactly what we deliver. We specialise in office construction and renovation, offering well-considered solutions, close partnerships and on-time delivery.



**NORDLIV BYG**  
**BUILDING  
TO HIGHER  
STANDARDS**

**04**

**MATAS**  
**TIMELESS SPACES  
AND MODERN WORK  
ENVIRONMENTS**

**10**

**ESC**  
**RESPONSIBLE  
CONSTRUCTION WITH  
A FOCUS ON THE FUTURE**

**13**

**NORDLIV BYG**  
**COMMERCIAL  
CONSTRUCTION  
THAT PAYS OFF**

**19**

# COLOPHON

## **PUBLISHER**

Nordliv Byg A/S  
Buddinge Hovedgade 205  
2860 Søborg  
CVR: 36694823  
info@nordlivbyg.dk

## **GRAPHIC DESIGN**

Nisted Bruun  
Reklamebureau a/s

**nordlivbyg.dk**



This catalogue is  
a Swan-and FSC  
certified print

**NORDLIV  
BYG**





**WE DELIVER  
WHAT WE PROMISE  
– AND BRING YOUR  
VISION TO LIFE**

NORDLIV BYG

# BUILDING TO HIGHER STANDARDS

QUALITY, PROJECT GOVERNANCE AND ACCOUNTABILITY AT EVERY STAGE

**In an industry where projects are often measured by deadlines, budgets and technical execution, we at Nordliv Byg have chosen a different approach. For us, construction is not only about craftsmanship – it is about people, collaboration and processes that create long-term value.**

We are far more than a traditional construction company. We operate as a guiding, advising and coordinating general contractor capable of managing both complex renovations and large-scale office projects for professional stakeholders in the commercial real-estate market.

With strong project management, transparency throughout the process and a deep understanding of modern workplaces, we have become a trusted partner for property managers, pension funds and companies that demand quality, stability and responsible management.

## **We lead the process – and take responsibility**

As general contractor, we set the direction, maintain the overview and ensure that all trades work together seamlessly. This requires structure, communication and the ability to translate needs into concrete solutions. To support this, we use digital project-management tools that provide complete transparency and ensure an efficient, well-coordinated process.

We are present throughout the entire journey – from the first sketches to the final details – ensuring that the client always knows where the project stands. Our role is to create

confidence, maintain control and ensure that solutions are completed correctly the first time. This approach is what makes us a stable and value-creating partner on large and complex construction projects.

## **A strong process begins with clear communication**

We know that the best results grow from a strong teamwork. That is why we prioritise open dialogue, clear expectation management and transparency in everything we do. Clients must be able to follow the project's development and have full insight into finances, decisions and progress.

**"For us, general contracting is not just about managing a project but about taking genuine responsibility for it. Our clients should feel that we lead the process, ensure the right direction and deliver exactly what we agreed. That is where we create our value."**

— ANDERS CORDER, CEO, NORDLIV BYG





We keep our agreements, speak plainly – and respond quickly when challenges arise. We are not flawless, but we take responsibility. That means our clients can rely on us. And that is also why they return with new projects.

### **We build modern workplaces**

Office construction requires more than technical execution – it requires insight into how people work, thrive and collaborate. We take a holistic approach to interior design, functionality and the work environment, from indoor climate and acoustics to materials and workflow.

Our experience across projects of all sizes allows us to deliver office environments that support efficiency, collaboration and employee wellbeing.

### **ESG – An integrated part of our DNA**

For us, ESG is not a standalone initiative but an integrated part of our business. Sustainability, accountability and integrity shape every decision – from planning to execution and operations.

#### **We actively work with:**

- Sustainable material handling and recycling
- Transparent processes and documentation
- A safe, healthy and developing work environment
- Responsible, long-term partnerships

**"We want to set the standard for how modern office construction can be planned and executed with respect for both people and the environment."**



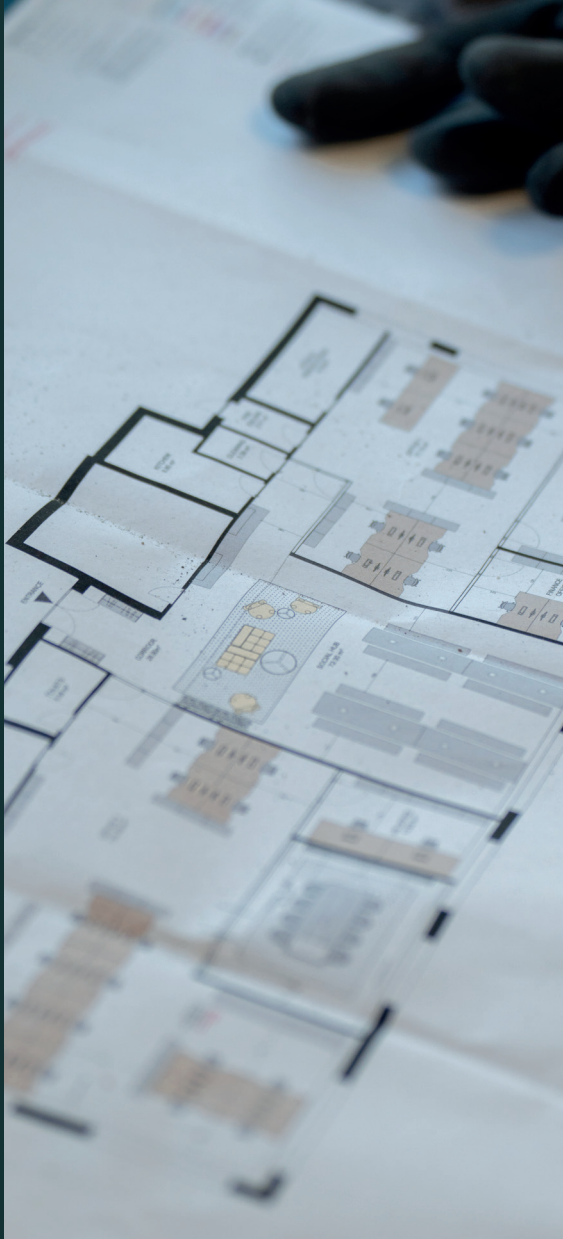

**We build offices, but in reality, we build frameworks for people. When functionality, wellbeing and integrity come together, the result is better – for both employees and the company. That is why our approach is always long-term, transparent and driven by quality at every stage**

— ANDERS CORDER, CEO, NORDLIV BYG

### **A workplace built on strong values**

We know that strong projects require strong people. That is why we are committed to fostering a culture where professionalism, wellbeing and responsibility go hand in hand.

We invest in our employees, create room for development and cultivate a working environment defined by integrity and collaboration.

This results in stable teams, high quality and a strong sense of security for our clients – and a workplace where people choose to stay for many years.

### **Our ambition**

We do not simply aim to follow developments in the industry – we want to help drive them.

**Every day, we work to create:**

- projects built on strong governance and high quality
- solutions that make a real difference
- partnerships based on clear dialogue and trust
- office environments that are modern, sustainable and future-ready

With this approach, we have positioned ourselves as a general contractor capable of managing even the most complex office projects – combining structure, transparency and genuine human integrity in a way that sets us apart.







# CLEVER

## A MODERN OFFICE WITH A FOCUS ON FUNCTION AND AESTHETICS

Nordliv Byg delivered a comprehensive office refurbishment for Clever, uniting modern functionality, flexible work zones and a refined aesthetic expression in one cohesive solution. The project involved a complete transformation of the office areas, with a strong focus on an inspiring work environment, sustainable materials and high execution quality – delivered as a general contracting assignment.

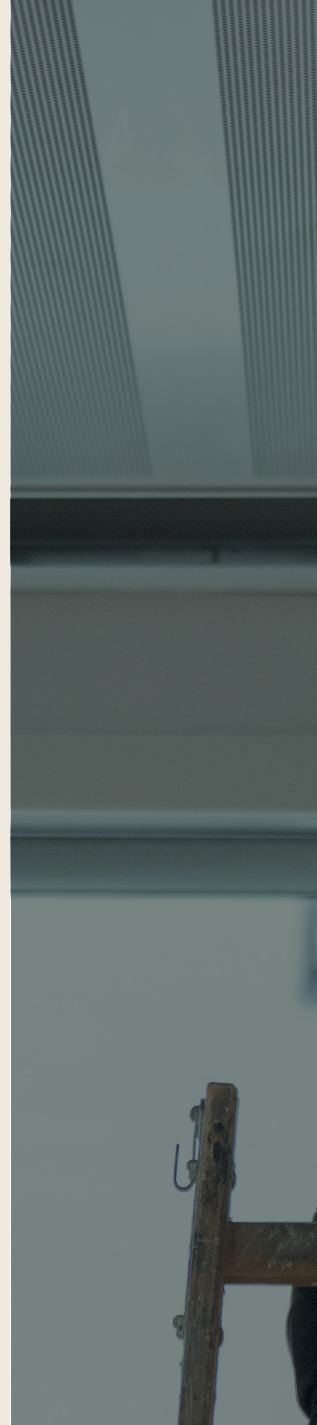





Year of completion:	2025
Client:	Clever
Contract type:	Main contract
Contract value:	4.300.000 kr.
Floor area	900 m <sup>2</sup>
Address:	Støberigade 12-14 København V





## MATAS

# TIMELESS FRAMES AND A MODERN WORK ENVIRONMENT AT MATAS

Nordliv Byg delivered an extensive office renovation for Matas in Allerød, renewing and adapting the existing facilities to meet the company's need for modern, flexible and contemporary workspaces. The project was carried out as a general contracting assignment and included both full-scale renovation and ongoing improvements, with a strong focus on functionality, employee wellbeing and an aesthetic office environment that supports the Matas brand and daily operations.







Year of completion: 2022 and ongoing renovation  
 Client: Matas  
 Contract type: Main contract  
 Contract value: 12.000.000 kr.  
 Floor area: 3.000 m<sup>2</sup>  
 Address: Rørmosevej 1  
 3450 Allerød





**WE BUILD  
OFFICE SPACES,  
WE BUILD  
TRUST AND  
WE BUILD  
LONGTERM  
PARTNERSHIPS.**



# ESG

## RESPONSIBLE CONSTRUCTION WITH A FOCUS ON THE FUTURE

**At Nordliv Byg, we see the green transition as a natural part of our work and our responsibility as a general contractor. We build solutions meant to last for many years, which is why we always think long-term – in our choice of materials, our partnerships and our processes.**

We work actively with ESG principles and integrate them throughout our value chain. It is not only about the environment, but equally about people, workplace safety and responsible project governance. For us, sustainability is not something that sits alongside the construction process – it is embedded in it.

### **Environment and responsible use of resources**

We continuously strengthen our material management, reduce waste and explore new methods for reuse and circular construction. We consider it a core responsibility to contribute to a construction industry that takes ownership of its impact – both today and for future generations.

By combining planning, structure and respect for materials, we deliver solutions that last longer, perform better and reduce environmental impact.

### **Social responsibility and a safe working environment**

For us, quality and wellbeing go hand in hand. We invest in our employees, develop their skills and ensure safe conditions that allow them to perform their work properly.

A healthy work environment leads to strong projects – and motivated employees remain the most valuable resource in any construction process.

### **A partner with accountability and perspective**

Regardless of project size, we work with transparency, reliability and clearly defined processes. We manage projects confidently from initial concept to final handover, taking responsibility for the resources entrusted to us.

ESG is not a separate initiative at Nordliv Byg – it is an integrated part of our professional practice and the way we operate as a company. We build with intention – for people, for materials and for the future.

**“We believe that good construction must also be responsible construction. That is why we work every day to do things a little better, a little smarter and a little more sustainably.”**

— ANDERS CORDER, CEO, NORDLIV BYG

# MOBILEPAY

## AN OPEN AND INSPIRING SPACE AT MOBILEPAY

Nordliv Byg completed a comprehensive office renovation in the bright and spacious facilities at Havneholmen. Delivered as a main contract, the project aimed to create an open and inspiring workspace with a sense of “high ceilings” – both literally and metaphorically.

The renovation includes flexible work zones, aesthetic details, and material choices that highlight the building's architecture while adding warmth to the clean lines of the interior. The result is a functional and welcoming office that encourages collaboration, creativity, and well-being in everyday work life







Year of completion: 2025  
 Client: Castellum  
 Tenant: MobilePay  
 Contract type: Main contract  
 Contract value: 9.200.000 kr.  
 Floor area: 1.800 m<sup>2</sup>  
 Address: Havneholmen 27-29  
 København V



# CASTELLUM

## DESIGN WITH CHARACTER

Nordliv Byg delivered an exclusive office renovation for Castellum at Havneholmen, where design, functionality and atmosphere are seamlessly integrated. The project combines soft lines and bold colours with a carefully curated selection of materials, creating a balance between aesthetics and a calm workspace.

The renovation was carried out as a main contractor assignment and includes new interior layouts, surface finishes and installations tailored to modern office needs. The result is an inspiring and dynamic workplace where every detail contributes to a cohesive whole – an office with character and comfort in perfect harmony.

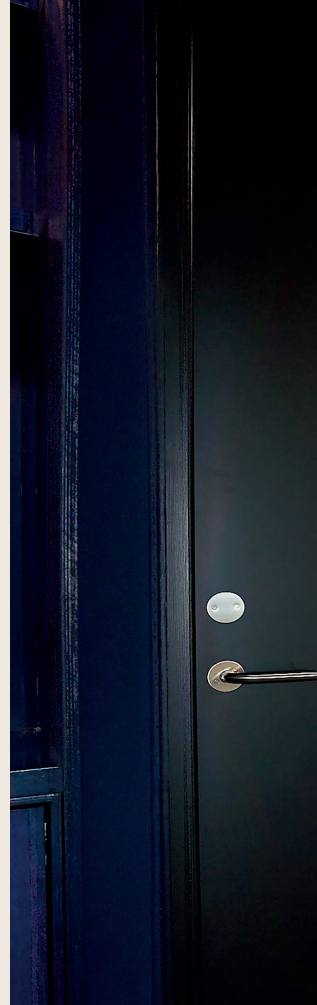





Year of completion: 2023  
 Client: Castellum  
 Contract type: Main contract  
 Contract value: 10.500.000 kr.  
 Floor area: 700 m<sup>2</sup>  
 Address: Havneholmen 25  
 1561 København V





**"WE DON'T EARN  
TRUST BY MAKING  
PROMISES, BUT BY  
DELIVERING."**



Commercial construction that pays off

# PEOPLE, FUNCTIONALITY AND AESTHETICS IN BALANCE

**At Nordliv Byg, we believe that successful commercial construction begins with an understanding of the client's day-to-day reality. When companies, institutions and organisations require new physical environments, it is not just a matter of building – but of creating solutions that add value to employees, operations and organisational culture alike.**

We specialise in commercial construction and office renovation, and our experience shows that good construction pays off – not only financially, but through improved employee wellbeing, better functionality and a stronger organisational identity.

With many years of experience and a wide network of skilled partners, we manage both full turnkey projects and main contractor assignments. We work with commercial portfolio owners, pension funds, property investors, municipalities, institutions, housing associations and large companies – always with a holistic approach. We combine aesthetics and functionality in solutions where quality, operational reliability and thoughtful design go hand in hand.

## **Office renovation**

### **– giving the workplace new life**

A modern office is more than a place to work. It is an environment that must support wellbeing, collaboration and efficiency. That is why we help our clients transform their offices into contemporary workspaces that reflect the organisation's culture and needs.

With us, you get solution-oriented craftsmen, detailed professional guidance and a collaboration defined by open dialogue. We deliver on time, we stand behind the quality – and we consider both the practical requirements and the aesthetic details that elevate everyday life.

Whether the need is improved acoustics, better space utilisation or a more inspiring interior, we create offices that function and add energy to the workspace

## **Why companies choose us**

When our clients choose Nordliv Byg, they gain more than a contractor. They gain a partner who takes responsibility for the entire process, from the first idea to the final finish.

We offer:

- Holistic advisory services
- Strong and efficient project management
- Local insight and reliable networks
- Long-lasting solutions – both visually and in quality

We do not build only to complete a project. We build to create value. That is what makes us a stable and trustworthy partner in commercial construction.



# PFA - NEWSEC

## INDUSTRIAL ELEGANCE

Nordliv Byg completed a tasteful and respectful office renovation for PFA - Newsec, preserving the building's original architecture and industrial character. Exposed timber beams and raw materials create an authentic "factory feel", blending historic character with modern functionality.

Delivered as a main contractor assignment, the project involved a full restoration with focus on aesthetics, quality, and respect for the existing structure. The result is an office environment where past and present meet in a harmonious and inspiring expression



Year of completion:	2025
Client:	PFA - Newsec
Contract type:	Main contract
Contract value:	2.300.000 kr.
Floor area:	1.800 m²
Address:	Artillerivej 86 København S









## JYSKE BANK

# LIGHT AND TRANSPARENCY

Nordliv Byg carried out the renovation of Jyske Bank's office facilities in Lyngby – a project where light and transparency define the overall concept. The new meeting and office areas appear bright, open and modern with a focus on both functionality and visual balance.

The renovation was delivered as a main contractor assignment and includes upgrades to the interior layout, surfaces and installations. The result is an inspiring and professional work environment where daylight, materials and spatial flow combine in harmonious balance.







Year of completion: 2025  
 Client: PFA – Newsec  
 Tenant: Jyske Bank  
 Contract type: Main contract  
 Contract value: 4.900.000 kr.  
 Floor area: 1.000 m<sup>2</sup>  
 Address: Klampenborgvej 215  
 Lyngby



What our clients say:

## **“NORDLIV BYG DELIVERS QUALITY, ACCOUNTABILITY AND STRONG PARTNERSHIP”**

“Lyngby-Taarbæk Municipality has, over an extended period, maintained a close partnership with Nordliv Byg as our trusted carpenter and primary contractor. Nordliv Byg has consistently delivered work of high quality — on time and at a fair, competitive price.

What particularly characterises Nordliv Byg is their professionalism and their ability to engage in constructive dialogue. They listen to our needs, provide well-considered recommendations and ensure that tasks are carried out with great care for our users. This approach results in solutions that are not only functional, but also thoughtfully adapted to the people who will use them in practice.

Nordliv Byg is also highly flexible and solution-oriented, making them an invaluable partner in our projects. We have always experienced a strong sense of accountability and commitment from their side, and we can therefore give Nordliv Byg our warmest recommendation to anyone seeking quality, reliability and a strong working partnership.”

Louise Toftebjerg Schneider  
Project manager  
Lyngby-Taarbæk Municipality

**NORDLIV  
BYG**

Nordliv Byg A/S  
Buddinge Hovedgade 205  
2860 Søborg

CVR: 3669 4823  
info@nordlivbyg.dk

**nordlivbyg.dk**